

# NEMA 42 Closed Loop Stepper Motor 110J12135EC-1000 Parameter

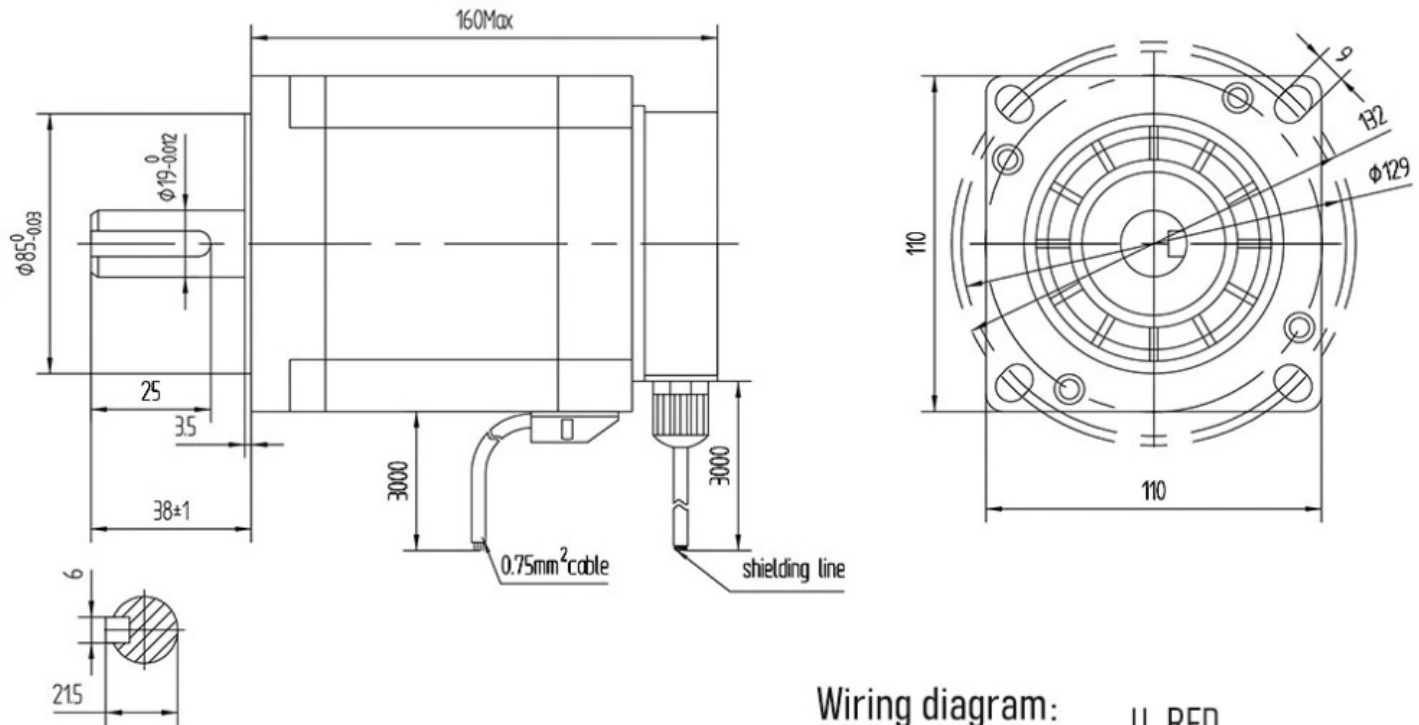

## Electrical specifications:

Phase	3
Step Angle (°)	1.2±5%
Current (A)	6
Resistance (Ω)	1±10%
Inductance (mH)	12±20%
Holding Torque (N.m)	12
Insulation Class	B
Insulation resistance	100M Ωmin.500VDC

## Wiring diagram:

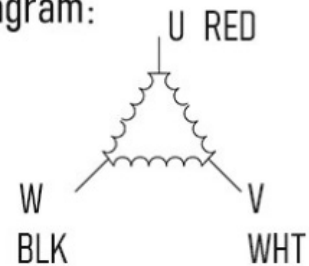

Note: Yellow-green wire is the ground wire.

## Encoder wiring:

PA+	PA-	PB+	PB-	VCC	GND
Black	Blue	Yellow	Green	Red	White

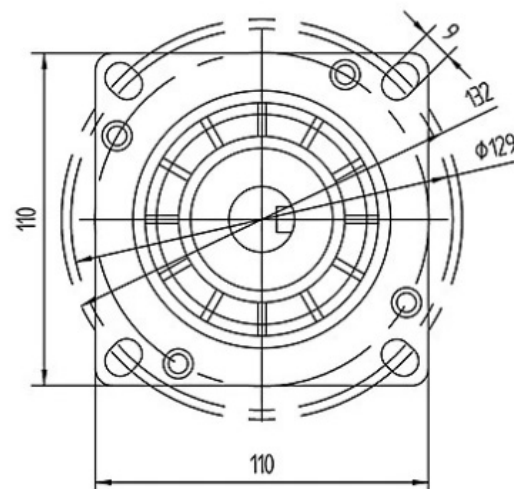
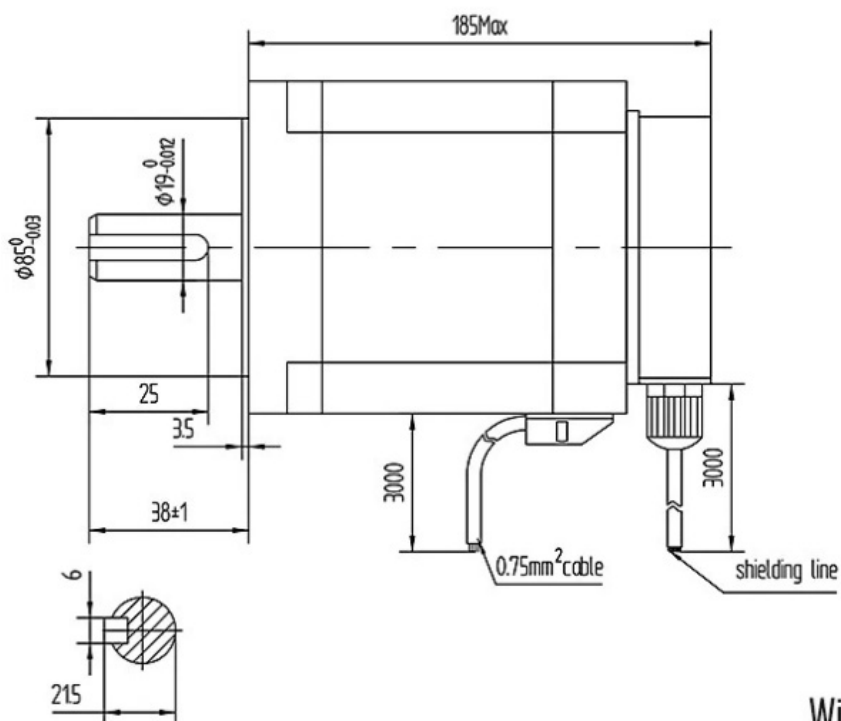

### Electrical specifications:

Phase	3
Step Angle ( $^{\circ}$ )	$1.2 \pm 5\%$
Current (A)	6
Resistance ( $\Omega$ )	$1 \pm 10\%$
Inductance (mH)	$14 \pm 20\%$
Holding Torque (N.m)	16
Insulation Class	B
Insulation resistance	$100\text{M}\Omega_{\text{min.500VDC}}$

### Wiring diagram:

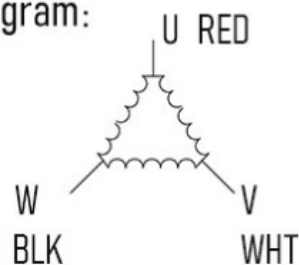

Note: Yellow-green wire is the ground wire.

### Encoder wiring:

PA+	PA-	PB+	PB-	VCC	GND
Black	Blue	Yellow	Green	Red	White

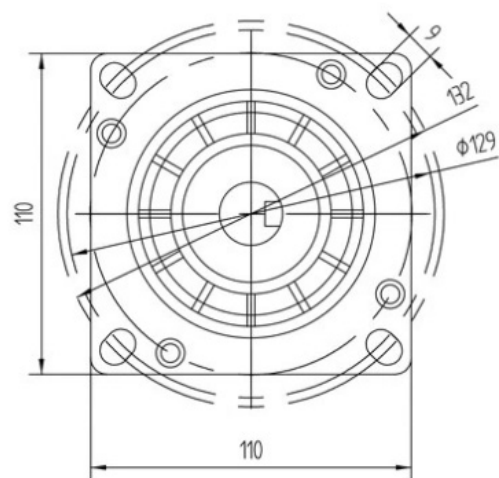

Wiring diagram:

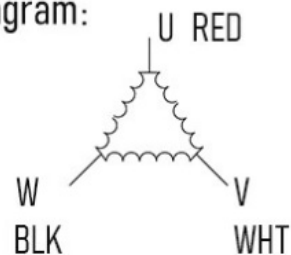

Encoder wiring:

PA+	PA-	PB+	PB-	VCC	GND
Black	Blue	Yellow	Green	Red	White

N.m

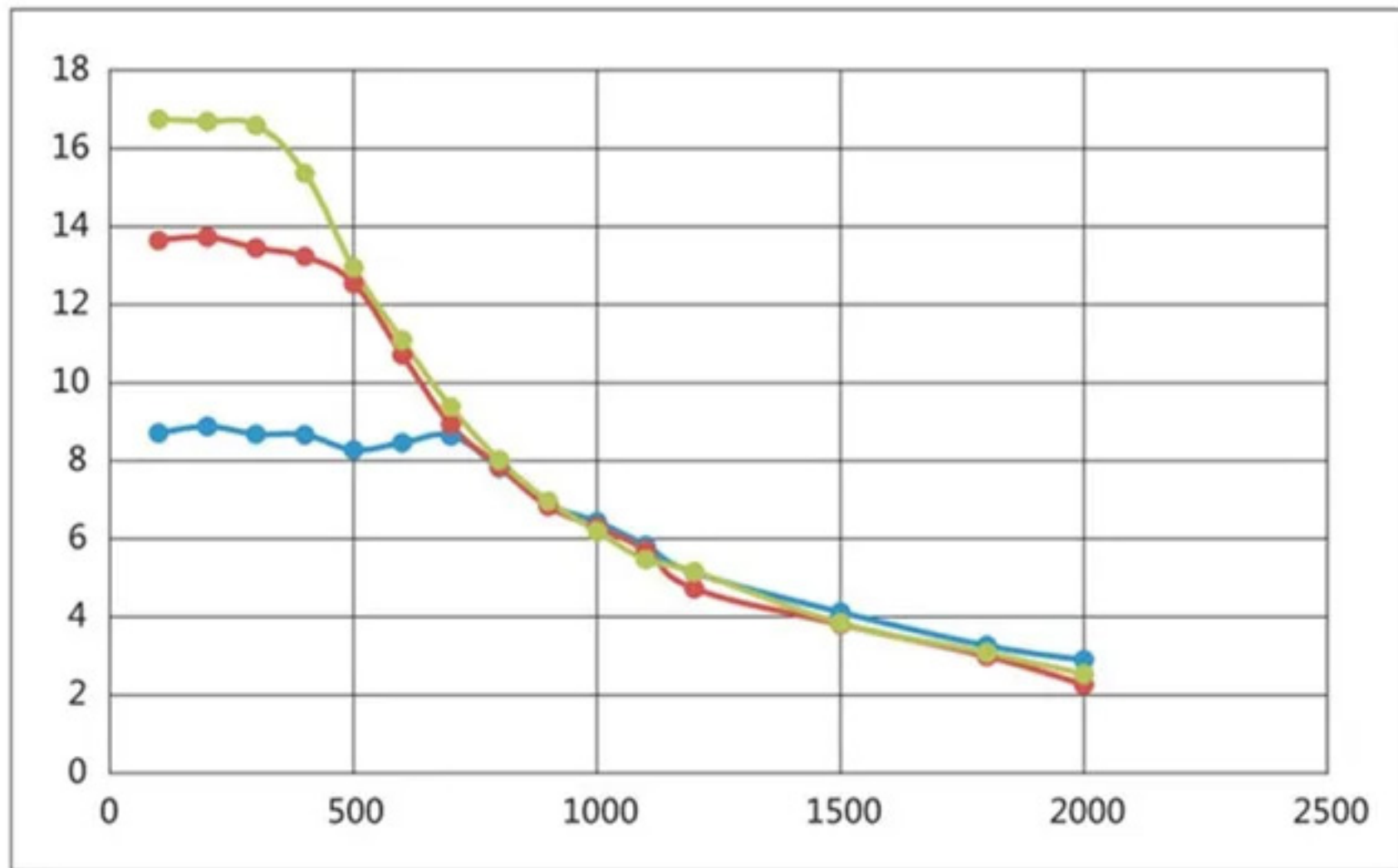

- 110J12135EC-1000/3HSS2208H 220VAC
- 110J12160EC-1000/3HSS2208H 220VAC
- 110J12190EC-1000/3HSS2208H 220VAC